

Front view and mounting

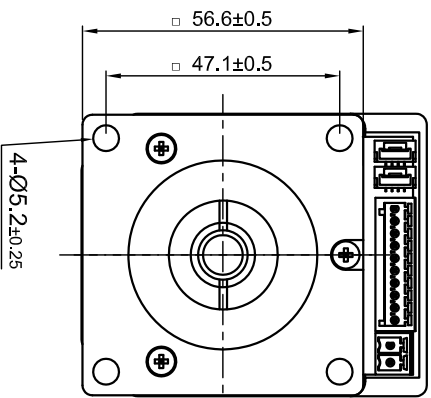

Side view

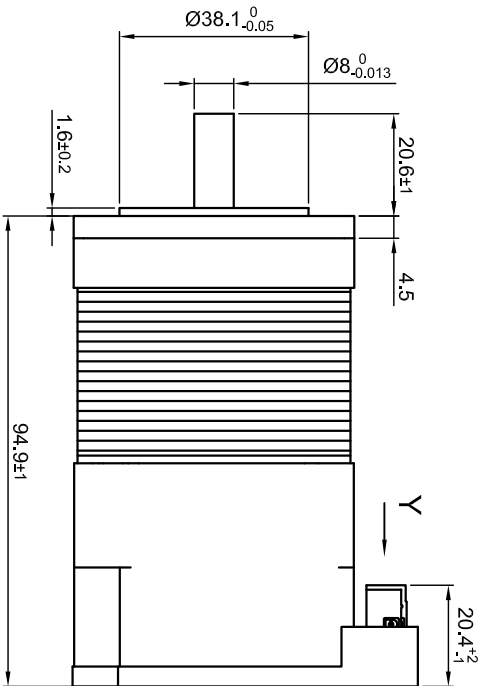

Rear view

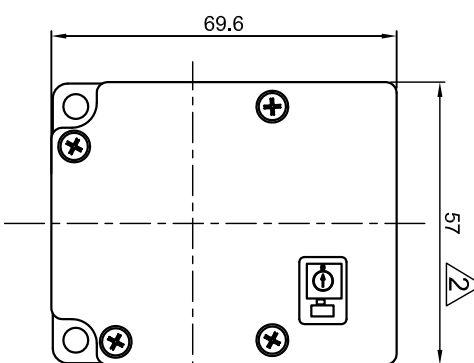

Y view

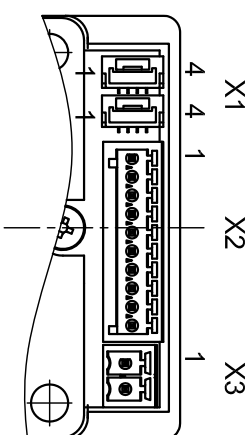

SPECIFICATION	CONNECTION
NO. OF POL./PHASE	STAR Δ
VOLTAGE RATED (VDC)	6/3
CURRENT RATED/PEAK (A)	24
TORQUE RATED/PEAK (Nm)	8/20
TORQUE CONSTANT (Nm/A)	0.37/0.92
BACK EMF (Vrms/Krpm)	0.046
POWER RATED (W)	3.8
SPEED RATED/NO LOAD (RPM)	135
WEIGHT (Kg)	3500±10%/5000±10%
	0.87

PERMISSIBLE RADIAL+AXIAL FORCE

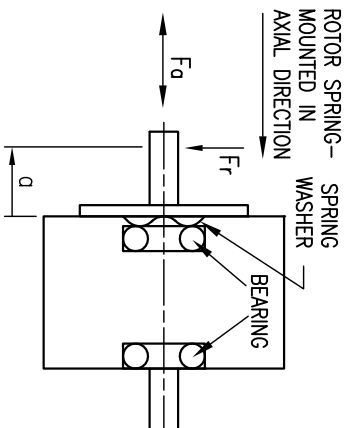

AXIAL-FORCE Fa (N)	15
DISTANCE a (mm)	20
RADIAL-FORCE Fr (N)	75
	AXIAL
	RADIAL
SHAFT PLAY (mm)	-0.1Mdx
AT LOAD MAX: (N)	40
	4.6

X1, JST GH-4		X2, Phoenix MCV-10	
PIN No.	Function	PIN No.	Function
1	+UB_L00G(24V)	1	GND
2	GAN+	2	Analog input (0-10V)
3	GAN-	3	+12V (Voltage Output, max:100mA)
4	GND	4	Output1 (open drain)
X3, Phoenix FMC-02		5	Output2 (open drain)
PIN No.	Function	6	Input1 (+5/+24V)
1	+VCC(12-24V)	7	Input2 (+5/+24V)
2	GND	8	Input3 (+5/+24V)
		9	Input4 (+5/+24V)
		10	GND

OVERTEMPERATURE PROTECTION (ELECTRONICS): 75°C Δ		AMBIENT TEMPERATURE -10~50°C [14F~122F] (HIGHER TEMPERATURE REDUCES DUTY CYCLE)		INSULATION RESISTANCE 100 Mohm (UNDER NORMAL TEMPERATURE AND HUMIDITY)		INSULATION CLASS B 130° [266F]		DIELECTRIC STRENGTH 500VAC FOR 1 MIN. (BETWEEN THE MOTOR COILS AND THE MOTOR CASE)		AMBIENT HUMIDITY MAX. 85% (NO CONDENSATION)	
02	REWORK DRAW/UPDATE DATA	19.07.16	GYQ	 Nanotec PLUG & DRIVE		Surface specification		General tolerances		Work piece edge	
01	TOLERANCE OF CONNECTOR LENGTH	28.01.14	GYQ			DIN ISO 1302	DIN ISO 2768-CH	DIN ISO 13715	APVD	CHKD	DRN
REV	DESCRIPTION	DATE	DRN			SIGNATURE		DATE		DATE	

PLUG&DRIVE MOTOR

DWG.NO PD4-CB59M024035-E-08