

Front view and mounting

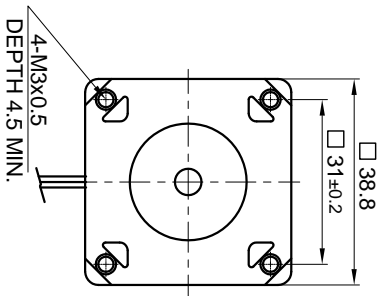

Side view

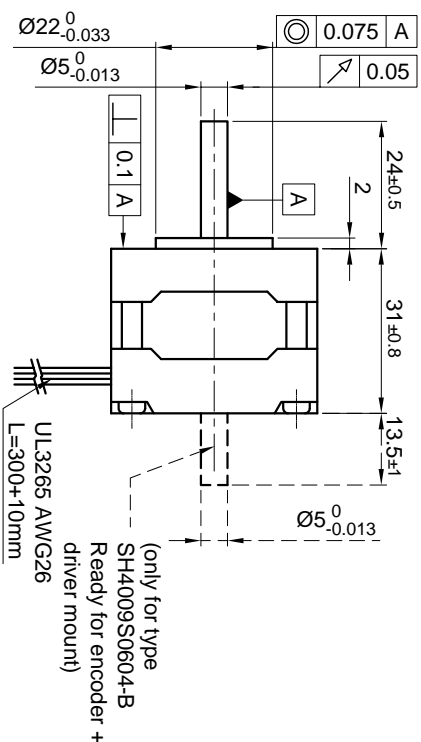

Rear view

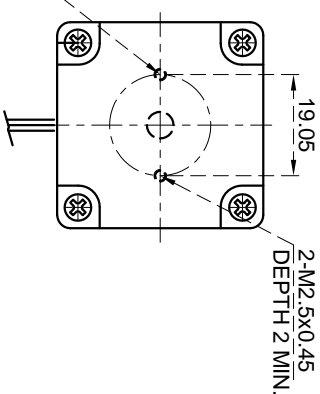

SPECIFICATION	CONNECTION	BIPOLAR
VOLTAGE (VDC)		5.7
AMPS/PHASE		0.63
RESISTANCE/PHASE (Ohms)@25°C		9.0±15%
INDUCTANCE/PHASE (mH) @1KHz		14±20%
HOLDING TORQUE (Nm) [lb-in]		0.121 [1.071]
DETENT TORQUE (Nm) [lb-in]		4.9×10 <sup>-3</sup> [0.043]
STEP ANGLE (°)		0.9
STEP ACCURACY (NON-ACCUM)		±5%
ROTOR INERTIA (kg-m <sup>2</sup> ) [lb-in <sup>2</sup> ]		1.7×10 <sup>-6</sup> [5.807×10 <sup>-3</sup> ]
WEIGHT (kg) [lb]		0.17 [0.375]
TEMPERATURE RISE: MAX.80°C (MOTOR STANDSTILL; FOR 2 PHASE ENERGIZED)		
AMBIENT TEMPERATURE -10°~ 50°C [14°F ~ 122°F]		
INSULATION RESISTANCE 100 Mohm (UNDER NORMAL TEMPERATURE AND HUMIDITY)		
INSULATION CLASS B 130° [266°F]		
DIELECTRIC STRENGTH 500VAC FOR 1 MIN. (BETWEEN THE MOTOR COILS AND THE MOTOR CASE)		
AMBIENT HUMIDITY MAX. 85% (NO CONDENSATION)		

PERMISSIBLE RADIAL+AXIAL FORCE

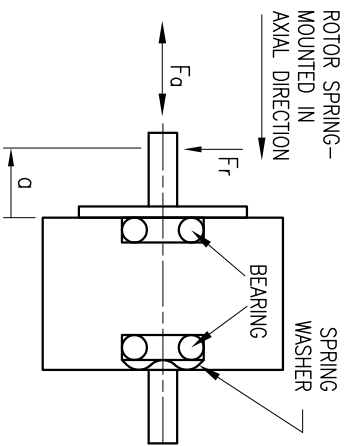

AXIAL-FORCE Fa (N)	Fr (N)	Fa=7
5	10	15
58	36	26
20	20	20

TYPE OF CONNECTION (EXTERN)	MOTOR
BIPOLAR	LEADS: BLU, RED, WHT, YEL WINDING: A, A\, B, B\

FULL STEP 2 PHASE-Ex,  
WHEN FACING MOUNTING END (X)

STEP	A	B	A\	B\	CCW	CW
1	+	+	-	-	↑	↓
2	-	-	+	+	↓	↑
3	+	+	-	-	↑	↓
4	-	-	+	+	↓	↑

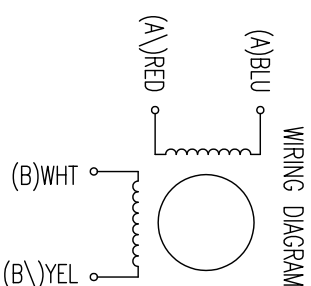

REV	DESCRIPTION	DATE	APVD

NANOTEC:	
SH4009S0604	

SCALE FREE	APVD	S.K.K.	12.06.06
X ±0.5	CHKD		
1PL ±0.2	DRN	J.W.	12.06.06
2PL ±0.1	SIGNATURE		
ANGLE ±30°	DATE		

STEPPING MOTOR	
DWG.NO	SH4009S0604